

Clarke®

STRONG-ARM



GANTRY CRANE

MODEL NO: CWGC1000

PART NO: 7612570

ASSEMBLY & USER INSTRUCTIONS

CE

ORIGINAL INSTRUCTIONS

GC0320 - ISS 1

INTRODUCTION

Thank you for purchasing this CLARKE Gantry Crane.

Before attempting to operate the product, it is essential that you read this manual thoroughly and carefully follow all instructions given. In doing so you will ensure the safety of yourself and that of others around you, and you can also look forward to the product giving you long and satisfactory service.

Please keep these instructions in a safe place for future reference.

SPECIFICATIONS

Model	CWGC1000
Max Capacity (SWL)	1000 kg (1 Tonne)
Net Weight	128 kg
Dimensions (L x W x H)	2600 x 1200 x 3720/2520 (max/min. height)
Maximum lift height	3600 mm
Minimum lift height	2395 mm

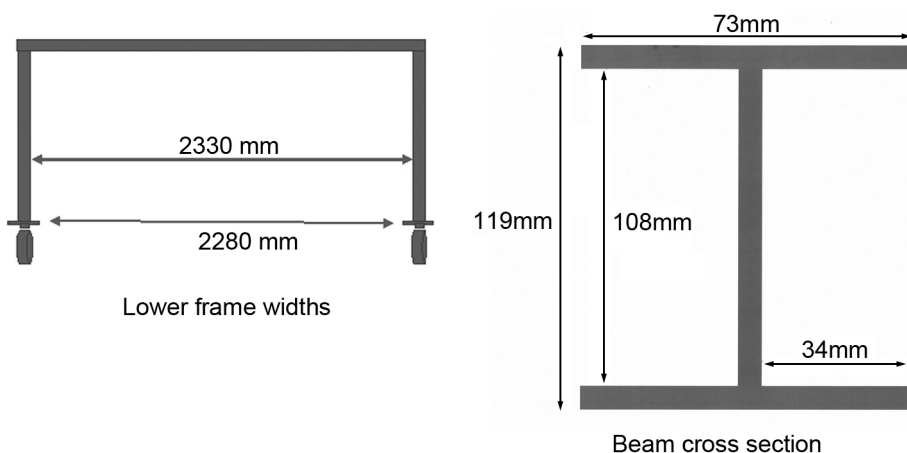

Widths are shown between the narrowest points (castor plates), and between the uprights.

SAFETY PRECAUTIONS

Always read instructions before setting up the equipment and before use. Failure to heed these warnings may result in damage to equipment or serious personal injury.

WORKPLACE SAFETY

1. ALWAYS inspect the gantry before use to ensure it is correctly assembled and in good condition and replace any damaged or worn parts.
2. Only use the gantry on a flat, solid, level surface preferably concrete which is capable of bearing the weight when loaded. Never work on soft/ unmade ground as the castors may sink in causing the gantry to topple.
3. Ensure the gantry operator is trained in both operation and safety aspects.
4. DO NOT allow personnel to use the gantry unless they have read these safety precautions.
5. Use the gantry in a suitable, well lit work area. which is tidy and free from unrelated items.
6. DO NOT use the gantry when you are tired or under the influence of alcohol, drugs or intoxicating medication.
7. Keep all bystanders at a safe distance whilst the gantry is in use.
8. DO NOT over-reach. Keep your proper footing and balance at all times.
9. Safety equipment such as gloves and non-skid safety shoes will reduce the possibility of personal injuries.

INSPECTION BEFORE USE

1. ALWAYS visually inspect the gantry before use, to ensure that all parts are correctly located and secure. Check for cracks, deformation or other signs of damage or worn parts and check the castors for damage. Do not use the gantry unless it is totally sound.
2. Check castors to ensure they move freely without undue wear to their pivots and that the wheels are not cracked or damaged.

SAFE OPERATING PRACTICE

1. Only use chains, slings, hooks etc. with a rated capacity equal to, or greater than that of the load and the gantry. Check that they are secure and will not slip under load.
2. NEVER exceed the safe working load capacities specified.

3. Lower the load as much as possible before moving the gantry. Do not use the gantry to transport loads over long distances.
4. DO NOT allow the load to swing or drop suddenly whilst moving or lowering.
5. DO NOT use this gantry to lift people or animals.
6. DO NOT work under any raised load.
7. NEVER climb on, or attempt to ride on the gantry.
8. Take care not to trap your fingers in the adjustable parts of the gantry.
9. Due to the weight of the loaded gantry, the help of an assistant will be beneficial when moving the gantry around.
10. This is a heavy item (128kg). Take care when positioning or adjusting.
11. NEVER attempt to move a loaded gantry across a floor having cracks, pebbles, or other obstacles which might impede its movement.
12. DO NOT move the gantry while heavily loaded in case it becomes unstable. Do not use the loaded gantry on sloping ground.
13. ALWAYS ensure the crossbeam is level at all times.
14. DO NOT leave the load suspended when the gantry is unattended.
15. ALWAYS ensure the load is centred beneath the beam before lifting.
16. ALWAYS apply the brakes on each of the castors when the gantry is not being moved around.
17. DO NOT push or pull the gantry crane with a fork truck or any other vehicle.

CARE OF THE GANTRY

1. Ensure that the gantry is properly maintained at all times and that no corrosion is allowed to weaken any components.
2. If replacing parts only use those supplied by CLARKE International.
3. If the gantry has been subjected to an abnormal load or shock it should be removed from service immediately and inspected by a qualified person.
4. NEVER tamper with the gantry or modify it in any way as this could prove to be dangerous and will invalidate the guarantee. Only use the gantry for the purpose for which it is intended.
5. The components of this gantry are designed to withstand the rated capacity. Do not substitute any other components or exceed the rated capacity of the gantry.
6. If the load capacity decal becomes worn or illegible contact CLARKE Parts and service department on 0208 988 7400 for a replacement.

UNPACKING AND PREPARATION

Using a clean level area, unpack and check/identity of all components including nuts, bolts and washers. Lay out and identify the components as shown in parts diagram on page 6.

During assembly, nuts and bolts should only be finger tightened. Final tightening can be carried out when assembly is completed.

Where bolts are mentioned, it is assumed that the appropriate washers, lock washers and nuts are also fitted.

COMPONENT PARTS

ITEM	DESCRIPTION	QTY
1	Bolt M12 x 35	24
2	12 dia washer	28
3	12 dia spring washer	28
4	M12 nut	28
5	Bolt M14 x 40	8
6	14 dia washer	8
7	14 dia spring washer	8
8	M14 nut	8
9	Locking Handle	4
10	Pivot Shaft	2
11	M10 nut	4
12	Hinge Pin	4
13	10 dia flat washer	20
14	Bolt M12 x 100	4
15	Bolt M10 x 30	16

ITEM	DESCRIPTION	QTY
16	10 dia spring washer	16
17	M10 nut	16
18	Pin	4
19	Crossbeam	1
20	Connecting plate	4
21	Inner vertical post	2
22	Support tube	4
23	Outer vertical post	2
24	Lifting Lever/Handle	2
25	Base frame	2
26	Castor wheel	4
27	Chain	2
28	Lifting hook	4
29	Washer	4
30	Split pin	4

COMPONENT PARTS

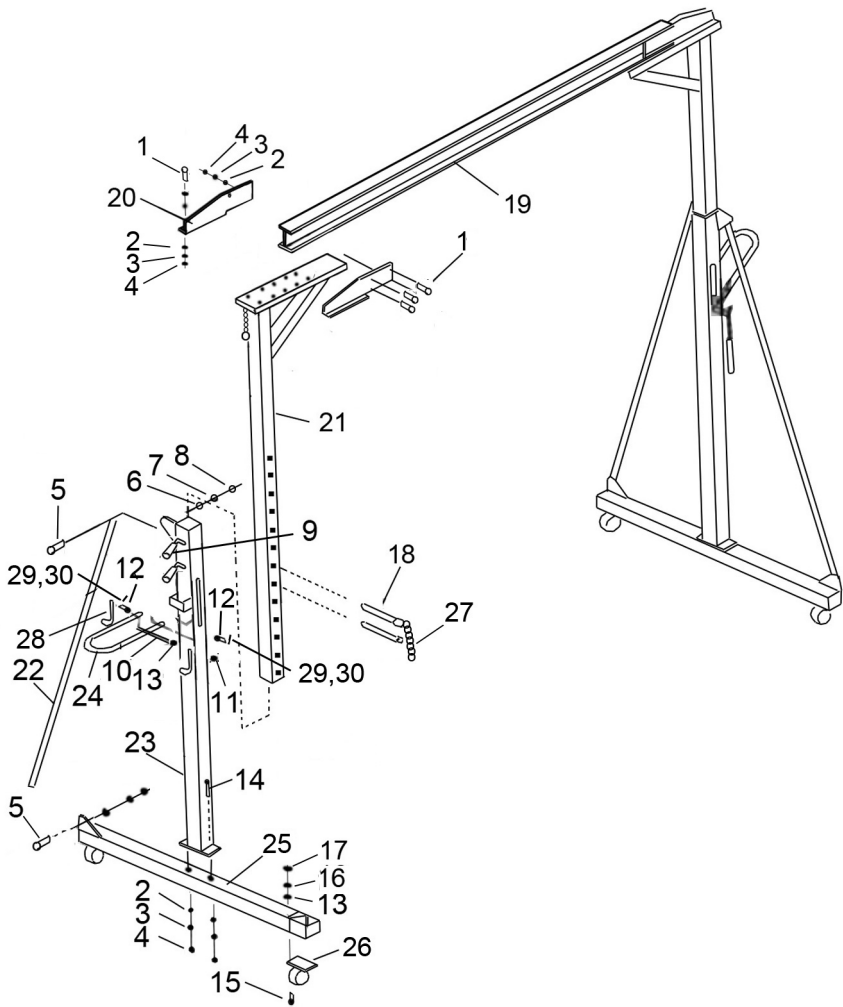

ASSEMBLY

REFER TO THE PARTS DIAGRAM ON PAGE 6

1. Take the outer vertical posts (23) and bolt them to the base frames (25) using the M12 x 100 bolts, nuts and washers shown (14, 2, 3, 4).
2. Take the four support tubes (22) and bolt them to the base frames (25) and outer vertical posts using M14 bolts (5), nuts and washers (6,7 & 8) at each end.
3. Screw the locking handles (9) to the outer posts (23).
4. Bolt the connecting plates (20) to the cross beam (19) before bolting the connecting plates to the inner vertical posts (21).
5. With the help of an assistant, insert the inner vertical posts (21) into the outer posts (23).
 - This may be best done with the assembly laying down.
6. Bolt the four castors (26) to the corners of the base frame assembly using M10 bolt, nuts and washers (15, 16 & 17).
7. Ensure that the inner uprights have slid into the outer uprights as far as they will go before standing the completed assembly upright.
8. Attach the lifting hooks (28) to the lifting handles (24) using the pivot pins, washers and split pins (29/30/31).
9. Connect the lifting handles to the frame using long cross bolts (10) and (12) with the M8 nuts (13).
10. Finally check to ensure that all nuts are fully tightened and the castors operate freely.

NOTE: DO NOT OVERTIGHTEN ANY PART WHICH MAY CAUSE DISTORTION

11. With the help of an assistant, raise the upper assembly to the height required and insert the locking pins (18) into the holes in each upright.
12. **EXERCISE GREAT CARE WHEN LIFTING/LOWERING HEAVY LOADS.** Make sure that any hoist, sling or hook is directly above the centre of gravity of the load.

USING THE GANTRY

INSTALLING A HOIST

1. Install a suitable chain block or hoist (not supplied) to the crossbeam following the instructions supplied with the hoist.
Note the dimensions of the crossbeam shown on page 2.

NOTE: When raising and lowering the crossbeam, always use two people and synchronise the raising/lowering operation.



LIFTING THE CROSSBEAM



WARNING: NOT NOT ATTEMPT TO ALTER THE CROSSBEAM HEIGHT WHILE UNDER LOAD.

1. Ensure the pin is in the lower location on each side as shown in Fig 3.
2. Loosen the two clamping handles on each side shown in Fig 2.

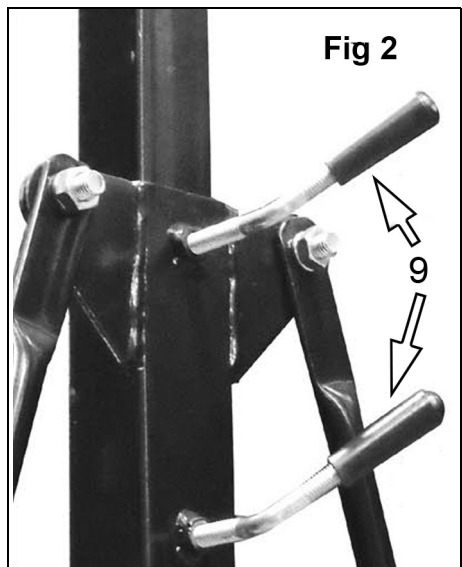

3. Engage the lifting hook with the pin in the lower location on each side.
4. Lift the lower pin by pressing down on the outer ends of the lifting levers.
5. When the next locating hole appears in the slot, insert the other pin into it (thus becoming the lower pin) and lower gently until it is bearing the weight of the parts above. Repeat until the required height is reached. (13 holes are provided).
6. Clamp the uprights by tightening the locking handles on each side.

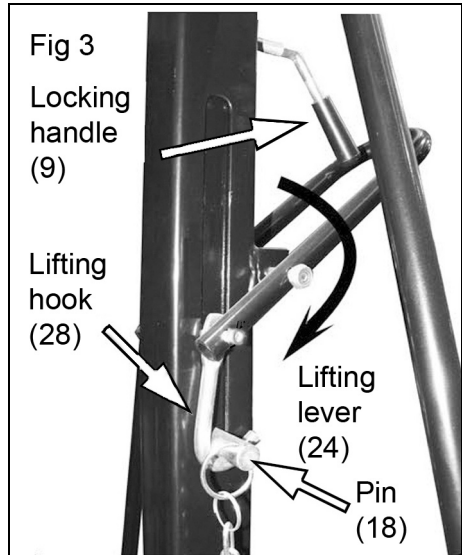

LOWERING THE CROSSBEAM

This should be performed in unison with both uprights, ensuring that the cross-beam stays level.

1. Loosen the locking handles.
2. Place the pin in the upper hole location.
3. Engage the lifting hook with the upper pin.
4. Using the lifting handles, lift the pin to release the weight on the lower pin.
5. Remove the lower pin and lower the upper pin gently to the lower location.
6. Repeat until the required height is reached.
7. Clamp the upright securely by tightening the clamping handles.

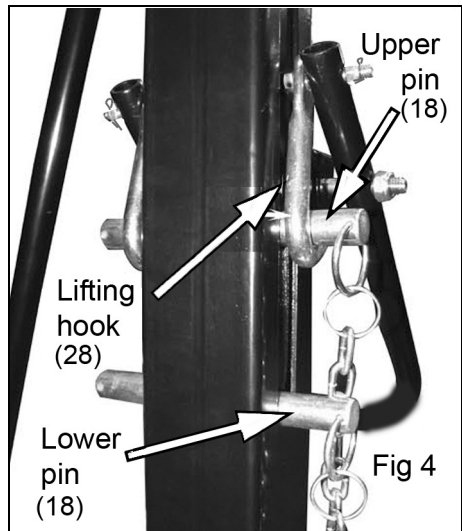

BEAM HEIGHT SETTINGS

The underside of the crossbeam can be set at the following heights above ground level.

1	2395 mm
2	2500 mm
3	2600 mm
4	2700 mm
5	2800 mm
6	2900 mm
7	3000 mm

8	3100 mm
9	3200 mm
10	3300 mm
11	3400 mm
12	3500 mm
13	3600 mm

CARE AND MAINTENANCE

1. Do not leave the gantry in the open or exposed to the elements. Keep it dry and clean under cover.
2. Always visually inspect the gantry before use, to ensure that all parts are correctly located and secure. Check for signs of damage or worn parts and check the wheels and castors for serviceability.
3. The gantry should be fully inspected annually by a competent person.
4. Each load-bearing bolt should be inspected for wear, deformation or cracks. If any are apparent, the bolt should be renewed, like for like.
5. Check the castors to ensure they move freely without undue wear to their spindles and that the wheels are not cracked or damaged.
6. Remove any rust and repaint to prevent further corrosion.
7. Ensure that warning labels are in place and clearly legible.

GUARANTEE

This CLARKE product is guaranteed against faulty manufacture for a period of 12 months from the date of purchase. Please keep your receipt as proof of purchase. This guarantee is invalid if the product is found to have been abused or tampered with in any way, or not used for the purpose for which it was intended. Faulty goods should be returned to their place of purchase, no product can be returned to us without prior permission. This guarantee does not effect your statutory rights.

DECLARATION OF CONFORMITY



Clarke[®]
INTERNATIONAL

Hemnall Street, Epping, Essex CM16 4LG

DECLARATION OF CONFORMITY

This is an important document and should be retained.

We hereby declare that this product(s) complies with the following directive(s):

2006/42/EC Machinery Directive.

The following standards have been applied to the product(s):

EN15011:2011+A1:2014

The technical documentation required to demonstrate that the product(s) meet(s) the requirement(s) of the aforementioned directive(s) has been compiled and is available for inspection by the relevant enforcement authorities.

The CE mark was first applied in: 2019

Product Description: 1 Tonne Gantry Crane
Model number(s): CWGC1000
Serial / batch Number: N/A
Date of Issue: 16/12/2019

Signed:

J.A. Clarke
Director

A SELECTION FROM THE VAST RANGE OF

Clarke®

QUALITY PRODUCTS

AIR COMPRESSORS

From DIY to industrial, Plus air tools, spray guns and accessories.

GENERATORS

Prime duty or emergency standby for business, home and leisure.

POWER WASHERS

Hot and cold, electric and engine driven - we have what you need

WELDERS

Mig, Arc, Tig and Spot. From DIY to auto/industrial.

METALWORKING

Drills, grinders and saws for DIY and professional use.

WOODWORKING

Saws, sanders, lathes, mortisers and dust extraction.

HYDRAULICS

Cranes, body repair kits, transmission jacks for all types of workshop use.

WATER PUMPS

Submersible, electric and engine driven for DIY, agriculture and industry.

POWERTOOLS

Angle grinders, cordless drill sets, saws and sanders.

STARTERS/CHARGERS

All sizes for car and commercial use.



PARTS & SERVICE: 0208 988 7400
E-mail: Parts@clarkeinternational.com or Service@clarkeinternational.com
SALES: UK 01992 565333 or Export 00 44 (0)1992 565335

Clarke® INTERNATIONAL Hemnall Street, Epping, Essex CM16 4LG
www.clarkeinternational.com